

Slide Switch SS Series

SS13D01

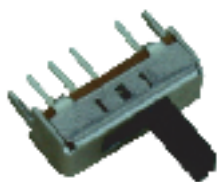

(SS-201B-13)

L=2 - 9

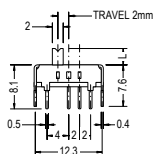
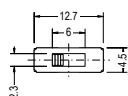

SCHEMATIC

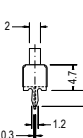

SPECIFICATION

- Circuit : ON-ON-ON(1P3T)
- Rating : D.C. 50V 0.3A
- Timing : Shorting

P.C.B. HOLE DETAIL

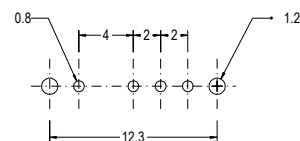

SS13F06

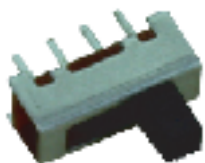

SCHEMATIC

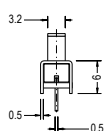
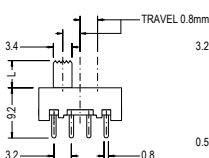
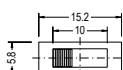

SPECIFICATION

- Circuit : ON-ON-ON(1P3T)
- Rating : D.C. 50V 0.5A
- Timing : Non Shorting

P.C.B. HOLE DETAIL

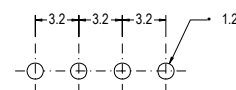

SS13F24

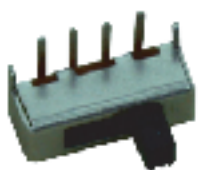

L=4 - 8

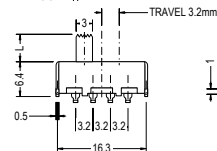
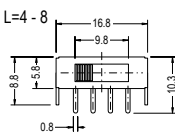

SCHEMATIC

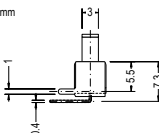

SPECIFICATION

- Circuit : ON-ON-ON(1P3T)
- Rating : D.C. 50V 0.5A
- Timing : Non Shorting

P.C.B. HOLE DETAIL

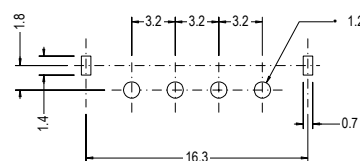

SS16F03

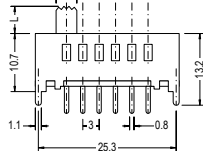
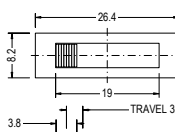
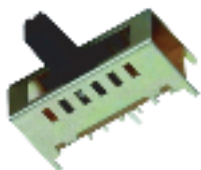

SCHEMATIC

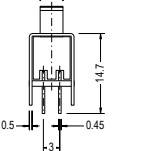

SPECIFICATION

- Circuit : ON-ON-ON-ON-ON-ON(1P6T)
- Rating : D.C. 50V 0.5A
- Timing : Shorting

P.C.B. HOLE DETAIL

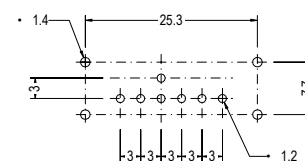

SS22D03



L=2 - 6

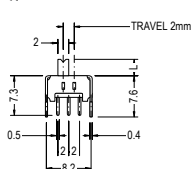
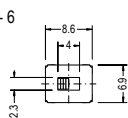

SCHEMATIC

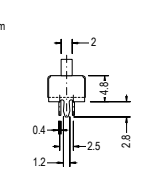

SPECIFICATION

- Circuit : ON-ON(2P2T)
- Rating : D.C. 50V 0.3A
- Timing : Non Shorting

P.C.B. HOLE DETAIL

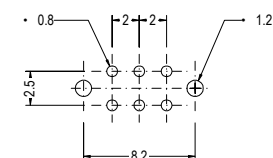

Slide Switch SS Series

SS22F03

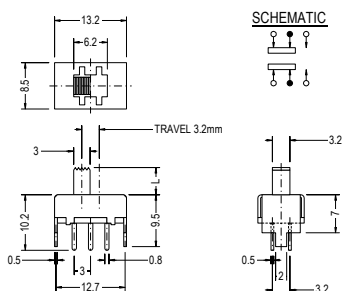

SPECIFICATION

- Circuit : ON-ON(2P2T)
- Rating : D.C. 50V 0.5A
- Timing : Non Shorting

P.C.B. HOLE DETAIL

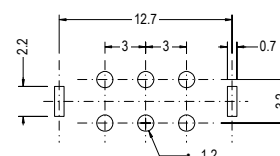

SS22F06



ON-ON(2P2T)

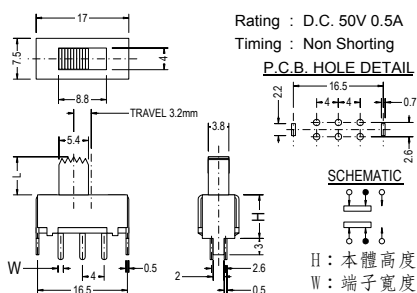

開關型號	高度(H)	端子(W)
SS-22F06	8	1.0
SS-22F07	8.5	1.0
SS-22F08	10	1.0
SS-22F10	9.5	1.0
SS-22F17	14	1.3
SS-22F18	14	0.9
SS-22F20	18	1.3
SS-22F22	21	1.3
SS-22F48	12	1.3
SS-22F50	11	1.3
SS-22F54	14	1.3

SS22F15

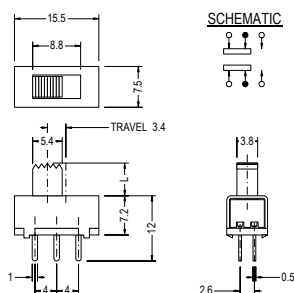

SPECIFICATION

- Circuit : ON-ON(2P2T)
- Rating : D.C. 50V 0.5A
- Timing : Non Shorting

P.C.B. HOLE DETAIL

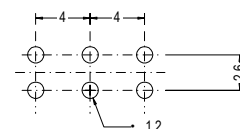

SS22F39



(SS-003-22)

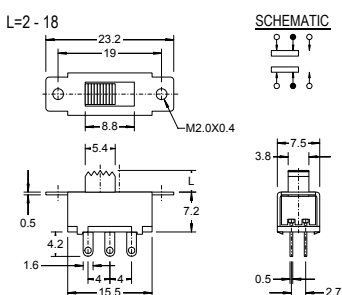

SPECIFICATION

- Circuit : ON-ON (2P2T)
- Rating : D.C. 50V 0.5A
- Contact R.[max] : D.C. 5V 1A 30m
- Insulation R.[min]: D.C. 500V 100M
- Withstand VOL. : A.C. 500V 1minute
- Operating force : 300 100g
- Timing : Non Shorting
- Life cycle[max] : 10,000 CYCLES

SS22K31

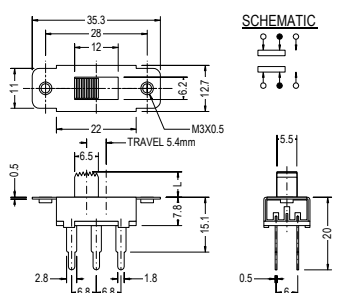
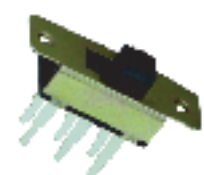

SPECIFICATION

- Circuit : ON-ON(2P2T)
- Rating : A.C. 250V 1.5A
- Timing : Non Shorting

P.C.B. HOLE DETAIL

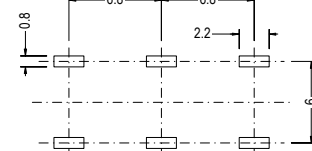

Slide Switch SS Series

SS22G08

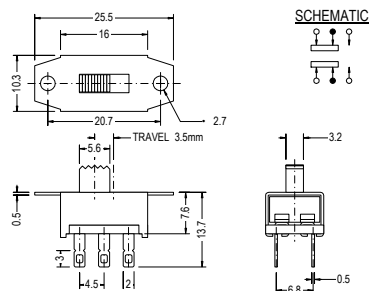
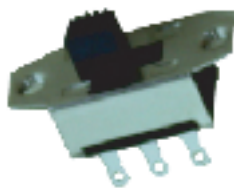

SPECIFICATION

- Circuit : ON-ON (2P2T)
- Rating : D.C. 50V 0.5A
- Contact R.[max] : D.C. 5V 1A 30m
- Insulation R.[min] : D.C. 500V 100M
- Withstand VOL. : A.C. 500V 1minute
- Operating force : 300 100g
- Timing : Non Shorting
- Life cycle[max] : 10,000 CYCLES

SS22H05

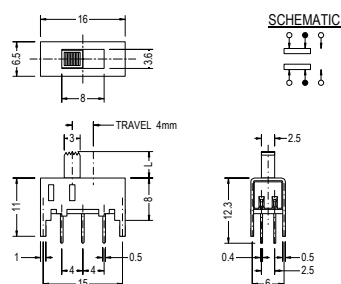

SPECIFICATION

- Circuit : ON-ON(2P2T)
- Rating : D.C. 50V 0.3A
- Timing : Non Shorting

P.C.B. HOLE DETAIL

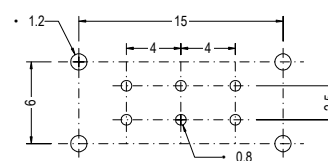

SS22H06

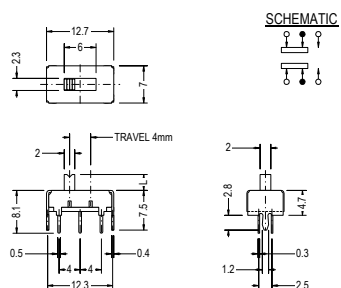

SPECIFICATION

- Circuit : ON-ON(2P2T)
- Rating : D.C. 50V 0.3A
- Timing : Non Shorting

P.C.B. HOLE DETAIL

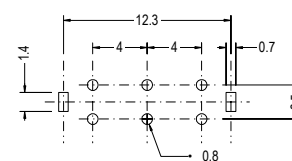

SS23D03

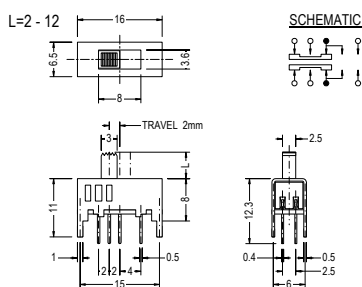
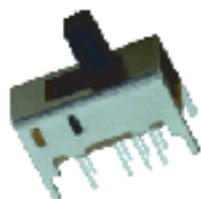

SPECIFICATION

- Circuit : ON-ON-ON(2P3T)
- Rating : D.C. 50V 0.3A
- Timing : Shorting

P.C.B. HOLE DETAIL

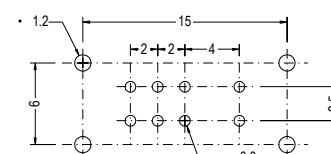

(SS-202-23)

SS23D05

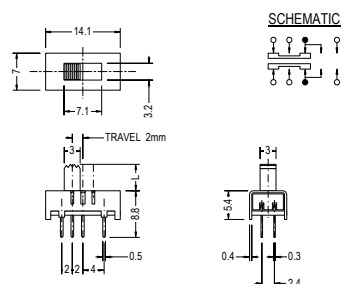

SPECIFICATION

- Circuit : ON-ON-ON(2P3T)
- Rating : D.C. 50V 0.3A
- Timing : Shorting

P.C.B. HOLE DETAIL

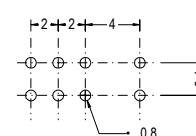



Slide Switch SS Series

SS23D06



(SS-201B-23)

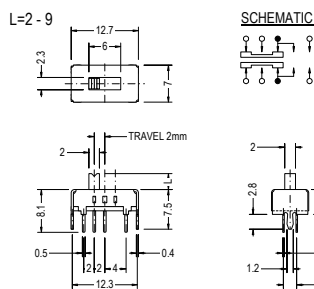

SPECIFICATION

- Circuit : ON-ON-ON(2P3T)
- Rating : D.C. 50V 0.3A
- Timing : Shorting

P.C.B. HOLE DETAIL

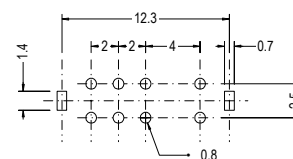

SS23D28

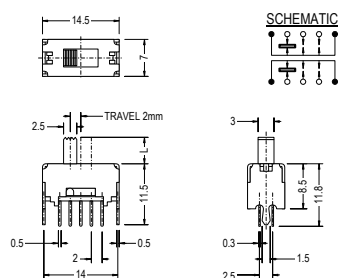
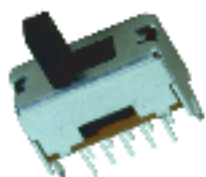

SPECIFICATION

- Circuit : ON-ON-ON(2P3T)
- Rating : D.C. 50V 0.3A
- Timing : Non Shorting

P.C.B. HOLE DETAIL

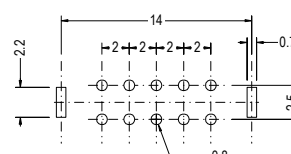

SS23E05

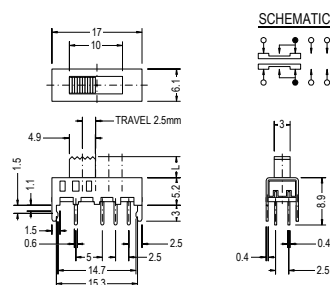
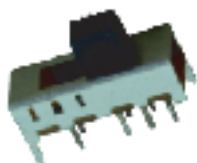

SPECIFICATION

- Circuit : ON-ON-ON(2P3T)
- Rating : D.C. 50V 0.3A
- Timing : Shorting

P.C.B. HOLE DETAIL

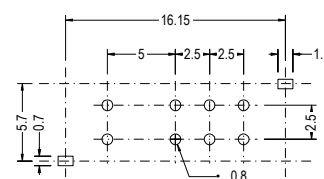

SS23E09

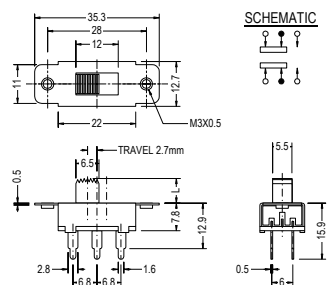
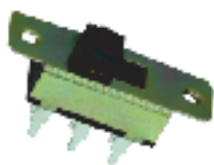

SPECIFICATION

- Circuit : ON-OFF-ON(2P3T)
- Rating : A.C. 250V 1.5A
- Timing : Non Shorting

P.C.B. HOLE DETAIL

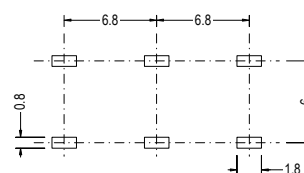

SS23F20

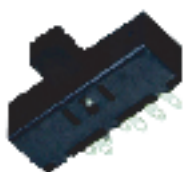

(SS-207)

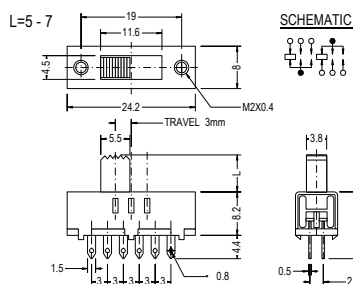

SPECIFICATION

- Circuit : ON-ON-ON (2P3T)
- Rating : D.C. 50V 0.5A
- Contact R.[max] : D.C. 5V 1A 30m
- Insulation R.[min] : D.C. 500V 100M
- Withstand VOL. : A.C. 500V 1minute
- Operating force : 300 100g
- Timing : Shorting
- Life cycle[max] : 10,000 CYCLES

Slide Switch SS Series

SS23F35

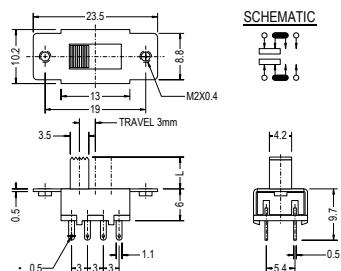
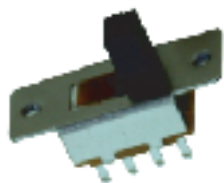

SPECIFICATION

- Circuit : ON-ON-ON (2P3T)
- Rating : D.C. 50V 0.3A
- Contact R.[max] : D.C. 5V 1A 30m
- Insulation R.[min]: D.C. 500V 100M
- Withstand VOL. : A.C. 500V 1minute
- Operating force : 300 100g
- Timing : Non Shorting
- Life cycle[max] : 10,000 CYCLES

SS23H02

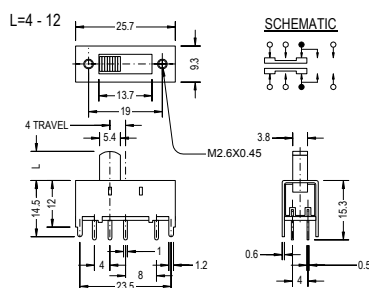

SPECIFICATION

- Circuit : ON-ON-ON(2P3T)
- Rating : D.C. 50V 0.3A
- Timing : Shorting

P.C.B. HOLE DETAIL

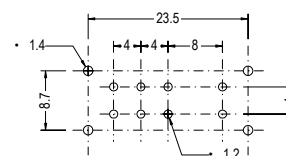

SS23L03

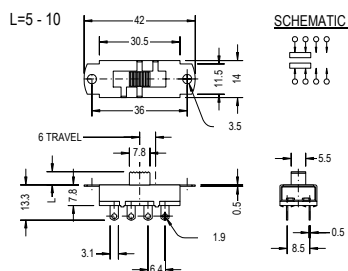
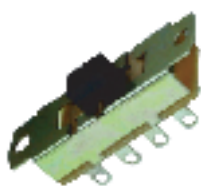

SPECIFICATION

- Circuit : ON-ON-ON (2P3T)
- Rating : A.C. 250V 3A
- Contact R.[max] : D.C. 5V 1A 30m
- Insulation R.[min]: D.C. 500V 100M
- Withstand VOL. : A.C. 500V 1minute
- Operating force : 300 100g
- Timing : Non Shorting
- Life cycle[max] : 10,000 CYCLES

SS24D02

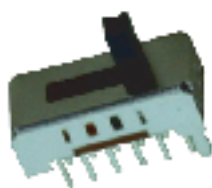

(SS-206)

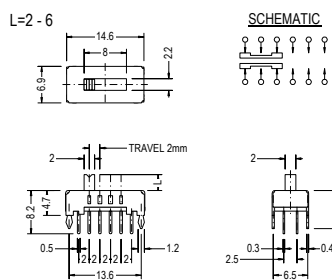

SPECIFICATION

- Circuit : ON-ON-ON-ON(2P4T)
- Rating : D.C. 50V 0.3A
- Timing : Shorting

P.C.B. HOLE DETAIL

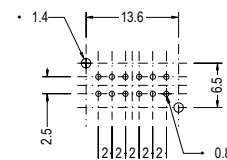

SS24E01

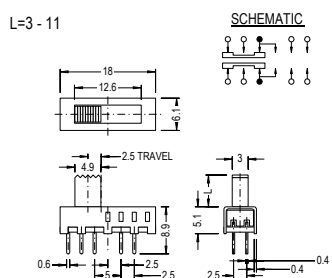

SPECIFICATION

- Circuit : ON-ON-ON-ON(2P4T)
- Rating : D.C. 50V 0.3A
- Timing : Shorting

P.C.B. HOLE DETAIL

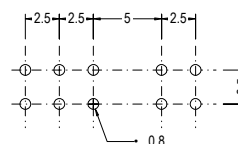

Slide Switch SS Series

SS24H03

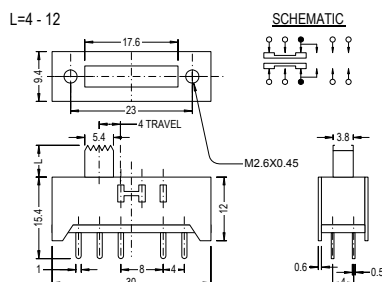

SPECIFICATION

- Circuit : ON-ON-ON-ON(2P4T)
- Rating : D.C. 50V 0.3A
- Timing : Shorting

P.C.B. HOLE DETAIL

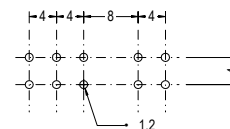

SS24N01

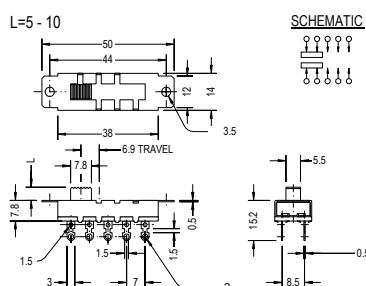
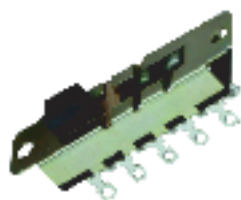

SPECIFICATION

- Circuit : ON-ON-ON-ON(2P4T)
- Rating : A.C. 250V 3A
- Contact R.[max] : D.C. 5V 1A 30m
- Insulation R.[min] : D.C. 500V 100M
- Withstand VOL. : A.C. 500V 1minute
- Operating force : 300 100g
- Timing : Non Shorting
- Life cycle[max] : 10,000 CYCLES

SS25F02

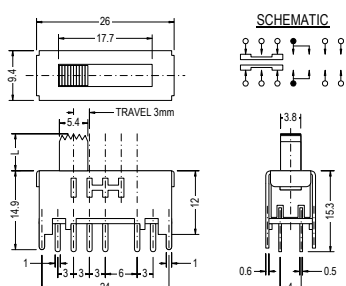

SPECIFICATION

- Circuit : ON-ON-ON-ON-ON(2P5T)
- Rating : D.C. 50V 0.3A
- Timing : Shorting

P.C.B. HOLE DETAIL

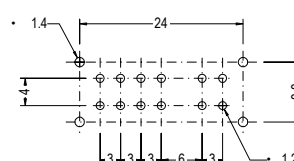

SS26D02

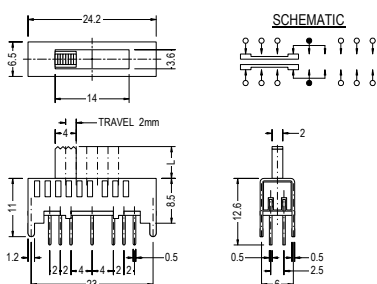
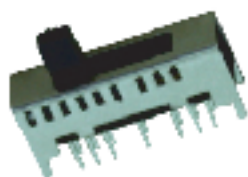

SPECIFICATION

- Circuit : ON-ON-ON-ON-ON-ON(2P6T)
- Rating : D.C. 50V 0.3A
- Timing : Shorting

P.C.B. HOLE DETAIL

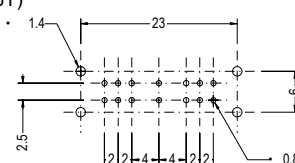

SS32H01

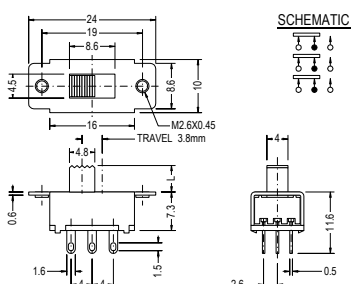

SPECIFICATION

- Circuit : ON-ON(3P2T)
- Rating : D.C. 50V 0.5A
- Contact R.[max] : D.C. 5V 1A 30m
- Insulation R.[min] : D.C. 500V 100M
- Withstand VOL. : A.C. 500V 1minute
- Operating force : 300 100g
- Timing : Non Shorting
- Life cycle[max] : 10,000 CYCLES